

# PHANTOM PM Series

Decorative Style Recessed Equipment  
12-Volt, Maintenance-Free, Long Life Lead-Calcium Battery  
**Evaluated to UL 924 Standards**

Blending into any environment, the Phantom PM Series emergency lighting unit goes unnoticed until it is needed. When AC power fails and the lights go out, the Phantom PM unit emerges to illuminate the path to safety. Once AC power is restored, the automated motor assembly drives the door back to the closed position.

## FEATURES

- **RELIABILITY:** The Phantom PM Series has a three-year full warranty (excluding lamps).
- **CONSTRUCTION:** Design combines ease of installation for the contractor and quality of finish for the architect or designer. The lighting assembly features a high quality, white finish. The heavy-duty, galvanized steel back box has no holes and a corrosion-resistant finish.
- **MOUNTING:** Recess mounts into walls or ceiling.
- **ELECTRONICS:**
  - ♦ Automatic, temperature-compensated, charger.
  - ♦ High capacity, automatic, dust tight instantaneous transfer relay.
  - ♦ Low voltage disconnect prevents over discharge of battery. Automatic brownout protection is provided.
  - ♦ Fused output circuits.
- **CONTROLS:**
  - ♦ Internally illuminated test switch.
- **POWER REQUIREMENTS:**
  - ♦ 120/277 Volt AC.

## APPLICATIONS

The "unseen solution" for use in walls or ceilings with a cavity. Ideally suited for any interior application where aesthetics are of importance.

## BATTERY

Long-life, maintenance-free sealed Lead-Calcium. Provides 90 minutes of emergency illumination.

## LAMP HEADS

The unit includes MR16 lamps supported by metallic swivels, with 100 degrees of aiming. MR16 lamps are available in 12, 20, 35 and 50 watts.

## UNIT SELECTION CHART

### Self-Powered Fixtures

12PM36-2(12)	.....12 watt heads (12-volt, 36 watts)
12PM54-2(12)	.....12 watt heads (12-volt, 54 watts)
12PM54-2(20)	.....20 watt heads* (12-volt, 54 watts)
12PM70-2(35)	.....35 watt heads* (12-volt, 70 watts)
12PM100-2(50)	.....50 watt heads* (12-volt, 100 watts)

\*Do not exceed rated unit capacity.

### Remote Fixtures (requires an external AC and DC source)

12PMR12-2	.....(2 heads, 12-volt, 12 watts each)
12PMR20-2	.....(2 heads, 12-volt, 20 watts each)
24PMR20-2	.....(2 heads, 24-volt, 20 watts each)
12PMR35-2	.....(2 heads, 12-volt, 35 watts each)
24PMR35-2	.....(2 heads, 24-volt, 35 watts each)
12PMR50-2	.....(2 heads, 12-volt, 50 watts each)
24PMR50-2	.....(2 heads, 24-volt, 50 watts each)

# PHANTOM PM Series



## ORDERING FORMAT

**12** **PM** **36** **-2** **(12)** **-ID**  
 ① ② ③ ④ ⑤ ⑥

- ① — **12** .....Voltage
- ② — **PM**.....Series
- ③ — **36** .....Wattage (See Unit Selection Chart)
- ④ — **-2** .....Number of Lamps Heads
- ⑤ — **(12)**.....Wattage of Lamps
- ⑥ — **-ID**.....Options

Custom colors and finishes available on request.

## ORDERING FORMAT (for Remote)

**12** **PMR** **12** **-2**  
 ① ② ③ ④

- ① — **12** .....Voltage
- ② — **PMR**.....Series
- ③ — **12** .....Wattage of Lamps  
(see remote selection chart)
- ④ — **-2** .....Number of Lamp Heads

## POWER CONSUMPTION CHART

AC Input	Maximum		Stand-By	
	Input Current (A)	Input Power (Watts)	Input Current (A)	Input Power (Watts)
120V	0.21	21	0.060	4
277V	0.09	21	0.025	4

## DIMENSIONS

Dimensions are approximate and subject to change.

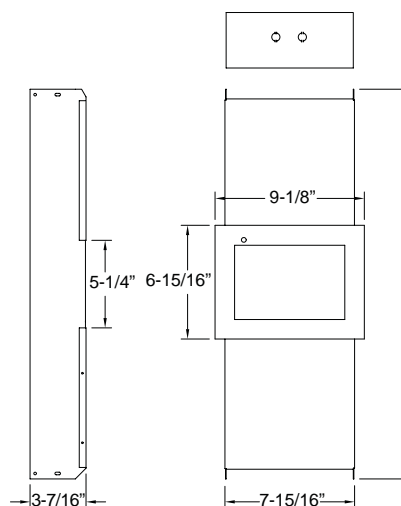

**Charger & Battery Compartment:**  
For use in walls or ceilings with a cavity, not for use in block walls or solid ceilings.  
\*\*23-3/4" for up to 12V 70W, 29" for 12V 100W\*  
\* (not suitable for T-Bar ceiling)

## UNIT RATING CHART

*Watts to 87-1/2% of rated battery voltage				
Model #	1-1/2 hrs.	2 hrs.	3 hrs.	4 hrs.
12PM36	36	24	-	-
12PM54	54	40	36	24
12PM70	70	48	40	28
12PM100	100	70	60	40

\*National Electrical Code Specification



## OPTIONS

(Add suffix to Model No.)

Improved Diagnostics.....**-ID**  
Less Back Box.....**-LBB\***

\*Unit must be installed with our back box to retain listing.

## ACCESSORIES

(Order as separate item)

Remote Test Switch .....**PSW**  
Back Box Only (36-70W Unit) .....**061243-L\***  
Back Box Only (100W Unit) .....**061266-L\***

\*Order only when back box is needed in advance.